

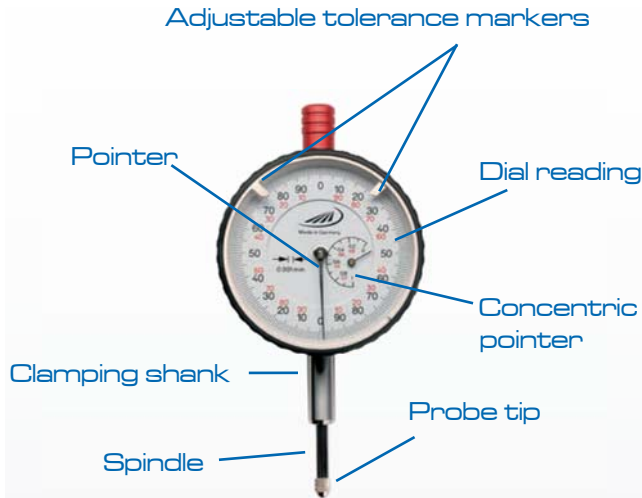

# SAMPLES INDICATORS



## Specifications

- Housing made from metal or polyamide
- Replacement probe tips M 2,5
- Shockproof devices available
- Water and oil proof devices available

## Electronic functions

**QuickStart Electronic:**  
Moving the spindle starts your measurement



**QuickLock Function:**  
Single keys can be locked individually



**Data Variable:**  
Interface for USB, RS 232 & Digimatic



**Integrated data transmission (Integrated Wireless)**



Individual tolerance limit values

Data Variable Interface



Combined analogue / digital display

# NEW

**1734i**  
with integrated wireless

## Matching accessories for our Indicators



MEASURING TABLES



MEASURING STANDS

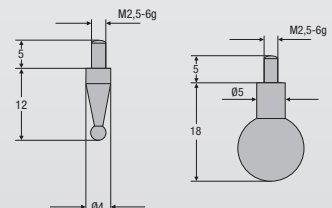

MEASURING INSERTS

### **3. CHAPTER INDICATORS**

122	Indicators
129	Dial gauges
134	Precision indicators
135	Accessories for dial gauges and precision indicators
137	Measuring inserts for dial gauges
141	Dial test indicators
143	Depth gauges, depth measuring base
144	Dial thickness gauges
146	Internal and external caliper gauges
150	Internal bore gauges for blind holes
151	Analogue internal precision bore gauges
153	Crankshaft gauges / Length measuring instruments
154	Length measuring instruments for internal incisions
155	Universal comparator gauge
158	Comparator gauge UHRTAST
164	Magnetic measuring stands
168	Measuring tables
171	Bench centres
176	Shaft measuring instruments



## 1722 / 1723 / 1724 DIGI-MET® Indicators



1722 502



1723 502



1724 502

### Model

- Housing Ø 60 mm
- Replacement probe tip M 2.5
- Protection class IP52
- Clamping shank Ø 8 mm
- LCD display with 12 mm high numerals
- Accuracy according to factory standard

### Functions

- ON / OFF
- **Quick-Start**
- **Quick-Lock** (key lock)
- Set to zero at any point
- Reversal of counting direction
- mm / inch switching
- Individual key lock

### Delivery

- Cardboard box

Marked	%	Measuring span	Resolution mm		Error limit	Measuring force	Order no.	List price
		mm	mm	inch	mm	N		EUR
		12.5	0.01	.0005	0.02	0.5 - 1	1722 502	138.00
		12.5	0.005	.0001	0.015	0.5 - 1	1723 502	174.00
		12.5	0.001	.00005	0.005	0.5 - 1	1724 502	284.00



1998720



1997501



1998501



1739920

### Accessories

	Order no.	List price
Battery, 3V-Lithium, CR 2032	0220 704	3.70
Data cable DATA VARIABLE to USB	1998 720	69.00
Data cable DATA VARIABLE to RS232	1997 501	48.00
Data cable DATA VARIABLE to digimatic	1998 501	61.00
Cable release	1739 920	14.30



## 1726 / 1728 DIGI-MET® Indicators



1726 502



1728 502

### Model

- Aluminium housing
- Hardened stainless steel spindle
- Outer ring (Bezel) Ø 60 mm
- Replacement probe tip M 2.5
- Protection class IP42
- Clamping shank Ø 8 mm
- Display unit can be rotated through 280°
- LCD display with 11 mm high numerals
- Factory standard

### Functions

- ON / OFF
- Quick-Start
- Quick-Lock (key lock)
- Set to zero at any point
- mm / inch switching
- ABS (display can be set to zero without losing the Preset value)
- TOL (tolerance value input)
- Reversal of counting direction
- Factor input
- Individual key lock
- PRESET-Function (setting a numerical value)
- Variable data output RS 232 + Digimatic + USB

### Delivery

- Cardboard box

»	¼	Measuring span	Resolution		Error limit		Repeatability	Measuring force	Order no.	List price
			mm	mm	inch	total span mm				
<b>Reading 0.001 mm</b>										
		12.5	0.001	.00005	0.004	0.002	0.001	0.65 - 0.9	1726 502	331.00
		25	0.001	.00005	0.004	0.002	0.001	0.65 - 1.15	1726 506	365.00
		50	0.001	.00005	0.007	0.002	0.001	1.25 - 2.7	1726 510	642.00
		100	0.001	.00005	0.008	0.002	0.001	1.6 - 3.5	1726 514	795.00
<b>Reading 0.01 mm</b>										
		12.5	0.01	.0005	0.02	-	0.01	0.65 - 0.9	1728 502	277.00
		25	0.01	.0005	0.02	-	0.01	0.65 - 1.15	1728 506	353.00
		50	0.01	.0005	0.02	-	0.01	1.25 - 2.7	1728 510	576.00
		100	0.01	.0005	0.02	-	0.01	1.6 - 3.5	1728 514	737.00

\* Reading switchable: 0.0005 / 0.001 / 0.002 / 0.005 / 0.010 mm

\*\* Partial span = 25 steps by step value 0.0005 mm



1998720

1998501

1997501

1739910

### Accessories

	Order no.	List price
Battery, 3V-Lithium, CR 2450	1998 770	5.70
Data cable DATA VARIABLE to USB	1998 720	69.00
Data cable DATA VARIABLE to RS232	1997 501	48.00
Data cable DATA VARIABLE to digimatic	1998 501	61.00
Cable release	1739 910	38.40



## 1730 / 1732 DIGI-MET® Indicators



### Model

- Aluminium housing
- Outer ring (Bezel) Ø 60 mm
- Replacement probe tip M 2.5
- Protection class IP54
- Clamping shank Ø 8 mm
- Display unit can be rotated through 280°
- LCD display with 11 mm high numerals
- Factory standard

### Functions

- ON / OFF
- Quick-Start
- Quick-Lock (key lock)
- Set to zero at any point
- mm / inch switching
- ABS (display can be set to zero without losing the Preset value)
- TOL (tolerance value input)
- Reversal of counting direction

### Delivery

- Cardboard box

⌘	¼	Measuring span		Resolution		Error limit		Repeatability	Measuring force	Order no.	List price
		mm		mm	inch	total span mm	partial span**mm				
		12.5		0.001	.00005	0.004	0.002	0.001	0.65 - 0.9	1730 502	367.00
		25		0.001	.00005	0.004	0.002	0.001	0.65 - 1.15	1730 506	414.00
		12.5		0.01	.0005	0.02	-	0.01	0.65 - 1.4	1732 502	310.00
		25		0.01	.0005	0.02	-	0.01	1 - 2.25	1732 506	391.00

\* Reading switchable: 0.0005 / 0.001 / 0.002 / 0.005 / 0.010 mm

\*\* Partial span= 25 steps by step value 0.0005 mm



### Accessories

	Order no.	List price
		EUR
Battery, 3V-Lithium, CR 2450	1998 770	5.70
Data cable DATA VARIABLE to USB	1998 720	69.00
Data cable DATA VARIABLE to RS232	1997 501	48.00
Data cable DATA VARIABLE to digimatic	1998 501	61.00
Cable release	1739 910	38.40



## 1734 DIGI-MET® indicators with combined analogue / digital display



1734 502



1734 506

### Model

- Aluminium housing
- Hardened stainless steel spindle
- Outer ring (Bezel) Ø 60 mm
- Replacement probe tip M 2.5
- Protection class IP42
- Clamping shank Ø 8 mm
- Display unit can be rotated through 280°
- LCD display with 8.5 mm high numerals
- Factory standard

### Functions

- ON / OFF
- **Quick-Start**
- **Quick-Lock** (key lock)
- Set to zero at any point
- mm / inch switching
- ABS (display can be set to zero without losing the Preset value)
- TOL (tolerance value input)
- MIN / MAX
- TIR (MIN-MAX differential)
- Reversal of counting direction
- Factor input
- Individual key lock
- Variable data output RS 232 + Digimatic + USB
- PRESET-Function (setting a numerical value)

### Delivery

- Cardboard box

»	%	Measuring span		Resolution		Error limit		Repeatability	Measuring force	Order no.	List price
		mm		mm	inch	total span mm	partial span**mm				
		12.5		0.001	.00005	0.004	0.002	0.001	0.65 - 0.9	1734 502	381.00
		25		0.001	.00005	0.004	0.002	0.001	0.65 - 1.15	1734 506	437.00

\* Reading switchable: 0.0005 / 0.001 / 0.002 / 0.005 / 0.010 mm

\*\* Partial span= 25 steps by step value 0.0005 mm



1998720

1998501

1997501

1739910

### Accessories

	Order no.	List price
Battery, 3V-Lithium, CR 2450	1998 770	5.70
Data cable DATA VARIABLE to USB	1998 720	69.00
Data cable DATA VARIABLE to RS232	1997 501	48.00
Data cable DATA VARIABLE to digimatic	1998 501	61.00
Cable release	1739 910	38.40



## 1734 DIGI-MET® indicator with combined analogue / digital display

for comparator gauges



1734 522

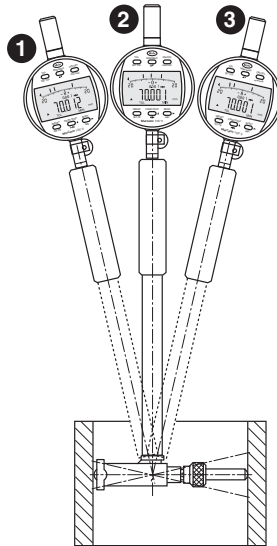

### Application

The turning point can be determined automatically in measurements with a 2 point internal measuring device through commutation. The actual value is detected and stored by the MIN function and appears on the display

### Model

- Aluminium housing
- Hardened stainless steel spindle
- Outer ring (Bezel) Ø 60 mm
- Replacement probe tip M 2.5
- Protection class IP42
- Clamping shank Ø 8 mm
- Display unit can be rotated through 280°
- LCD display with 8.5 mm high numerals
- Factory standard

### Functions

- ON / OFF
- **Quick-Start**
- **Quick-Lock** (key lock)
- Set to zero at any point
- mm / inch switching
- ABS (display can be set to zero without losing the Preset value)
- TOL (tolerance value input)
- MIN / MAX
- Reversal of counting direction
- Factor input
- Individual key lock
- Variable data output RS 232 + Digimatic + USB
- PRESET-Function (setting a numerical value)

### Delivery

- Cardboard box

Marked	Marked	Measuring span		Resolution		Error limit		Repeatability	Measuring force	Order no.	List price
		mm		mm	inch	total span mm	partial span**mm				
		12.5		0.001	.00005	0.004	0.002	0.001	0.65 - 0.9	1734 522	494.00

\* Reading switchable: 0.0005 / 0.001 / 0.002 / 0.005 / 0.010 mm

\*\* Partial span= 25 steps by step value 0.0005 mm



### Accessories

	Order no.	List price
Battery, 3V-Lithium, CR 2450	1998 770	5.70
Data cable DATA VARIABLE to USB	1998 720	69.00
Data cable DATA VARIABLE to RS232	1997 501	48.00
Data cable DATA VARIABLE to digimatic	1998 501	61.00
Cable release	1739 910	38.40



## 1726i / 1734i DIGI-MET® Indicators with integrated wireless



172650 260



173450 260



### integrated iw wireless

# NOVELTY

Data transmission without cable or radio module

3

### Model

- Aluminium housing
- Outer ring (Bezel) Ø 60 mm
- Replacement probe tip M2.5
- Protection class IP42
- Clamping shank Ø 8mm
- Display can be rotated through 280°
- LCD display with 11 mm high numerals
- Factory standard

### Functions

- ON / OFF
- Quick-Start**
- Quick-Lock** (key lock)
- Set to zero at any point
- mm / inch switching
- ABS (display can be set to zero without losing the Preset value)
- TOL (tolerance value input)
- Reversal of counting direction

### Delivery

- Cardboard box

»	¼	Measuring span	Resolution		Error limit		Repeatability	Measuring force	Order no.	List price
		mm	mm	inch	total span mm	partial span**mm	mm	N		EUR
		12.5	0.0005	.00002	0.004	0.002	0.001	0.65 - 0.9	172650 260	391.00
		25	0.0005	.00002	0.004	0.002	0.001	0.65 - 1.15	172650 660	425.00
<b>With combined analogue / digital display and MIN / MAX / TIR Function</b>										
		12.5	0.0005	.00002	0.004	0.002	0.001	0.65 - 0.85	173450 260	441.00
		25	0.0005	.00002	0.004	0.002	0.001	0.65 - 0.9	173450 660	497.00

\* Reading switchable: 0.0005 / 0.001 / 0.002 / 0.005 / 0.010 mm

\*\* Partial span= 25 steps by step value 0.0005 mm



1739910



1998780

### Accessories

	Order no.	List price EUR
Battery, 3V-Lithium, CR 2450	1998 770	5.70
Cable release	1739 910	38.40
i-Stick USB-receiver for Integrated Wireless	1998 780	97.00

Integrated Wireless is intended to be sold in the EU only





## 0691 DIGI-MET® Indicators



### Model

- Aluminium housing
- Outer ring (Bezel) Ø 60 mm
- Replacement probe tip M 2.5
- Protection class IP51
- Water and coolant resistant
- Clamping shank Ø 8 mm
- Display unit can be rotated through 270°
- LCD display with 11 mm high numerals
- Factory standard

### Functions

- ON / OFF
- Set to zero at any point
- mm / inch switching
- PRESET-Function (setting a numerical value)
- Reversal of counting direction
- Data interface RS232 Proximity (cable no. 1998 760)

### \* Additional functions models 0691 751 + 0691 753

- TOL (tolerance value input)
- Factor input
- MIN / MAX
- TIR (MIN-MAX differential)

### Delivery

- Cardboard box



0691 733



0691 735



0691 747



Marked	Marked	Measuring span		Resolution		Error limit	Order no.	List price
		mm	mm	inch	mm			
<b>Reading 0.01 mm</b>								
		12.5	0.01	.0005	0.01	0691 731	363.00	
		25	0.01	.0005	0.01	0691 733	416.00	
		50	0.01	.0005	0.02	0691 735	905.00	
		100	0.01	.0005	0.02	0691 737	1020.00	
<b>Reading 0.001 mm</b>								
		12.5	0.001	.00005	0.004	0691 741	448.00	
		25	0.001	.00005	0.005	0691 743	491.00	
		50	0.001	.00005	0.007	0691 745	1003.00	
		100	0.001	.00005	0.008	0691 747	1158.00	
<b>Reading 0.001 mm. with additional functions*</b>								
		12.5	0.001	.00005	0.003	0691 751	521.00	
		25	0.001	.00005	0.004	0691 753	576.00	



0701 Small dial gauges with lightweight plastic housing



**Model**

- Lightweight housing made of polyamide
- Measuring spindle is made of stainless steel
- Replacement probe tip M 2.5
- Clamping shank Ø 8 mm
- DIN 878

**Delivery**

- Fitted case

DIN  
878

»	¼	Measuring span mm	Scale graduation value mm	Range per rev. mm	Outer ring (Bezel) Ø mm	Order no.	List price EUR
<b>Small dial gauge</b>							
		5	0.01	0.5	40	0701 101	40.00
<b>Shockproof small dial gauge</b>							
		5	0.01	0.5	40	0701 102	50.00

3

0708 Small dial gauges



0708 101



0708 102

**Model**

- Metal housing
- Measuring spindle is made of stainless steel
- Replacement probe tip M 2.5
- Clamping shank Ø 8 mm
- With a revolution counter
- DIN 878

**Delivery**

- Fitted case

DIN  
878

»	¼	Measuring span mm	Scale graduation value mm	Range per rev. mm	Outer ring (Bezel) Ø mm	Order no.	List price EUR
		10	0.01	0.5	40	0708 101	86.00
		5	0.01	0.5	40	0708 102	55.00
		3	0.01	0.5	32	0708 103	66.00
		3	0.01	0.5	40	0708 104	45.00
<b>Shockproof small dial gauge</b>							
		3	0.01	0.5	40	0708 105	55.00
		5	0.01	0.5	40	0708 106	73.00



## 0701 Dial gauges



**DIN  
878**



0701 106



0701 110

### Model

- Measuring spindle is made of stainless steel
- Replacement probe tip M 2.5
- Clamping shank Ø 8 mm
- DIN 878
- 0701103 = Factory standard

### Delivery

- Fitted case

⌘	¼	Measuring span mm	Scale graduation value mm	Range per rev. mm	Outer ring (Bezel) Ø mm	Order no.	List price EUR
<b>Dial gauge, plastic housing</b>							
		10	0.01	1	58	0701 103	23.00
<b>Shockproof dial gauge, injection-moulded housing</b>							
		10	0.01	1	56	0701 106	24.00
<b>Dial gauge, metal housing</b>							
		10	0.01	1	58	0701 110	40.00
<b>Shockproof dial gauge, metal housing</b>							
		10	0.01	1	58	0701 111	46.00

## 0703 Dial gauges with extended measuring range



0703 101

### Model

- Metal housing
- Measuring spindle is made of stainless steel
- Replacement probe tip M 2.5
- Clamping shank Ø 8 mm
- With a concentric pointer
- Factory standard

### Delivery

- Fitted case

⌘	¼	Measuring span mm	Scale graduation value mm	Range per rev. mm	Outer ring (Bezel) Ø mm	Order no.	List price EUR
		30	0.01	1	58	0703 101	99.00
		50	0.01	1	58	0703 104	137.00
		80	0.01	1	58	0703 107	275.00



## 0704 Shockproof dial gauges



0704 105



0704 109

### Model

- Metal housing
- Measuring spindle is made of stainless steel
- Replacement probe tip M 2.5
- Clamping shank Ø 8 mm
- Shockproof

### Delivery

- Fitted case

DIN 878

»	¼	Measuring span mm	Scale graduation value mm	Range per rev. mm	Outer ring (Bezel) Ø mm	Order no.	List price EUR
<b>Revolution counter: DIN 878</b>							
		10	0.01	1	58	0704 105	70.00
<b>With fine adjustment of the pointer: DIN 878</b>							
		10	0.01	1	58	0704 106	86.00
<b>Concentric pointer: Factory standard</b>							
		30	0.01	1	58	0704 109	113.00
		50	0.01	1	58	0704 110	146.00

## 0707 Water and oil proof dial gauges



0707 102

### Model

- Metal housing, water and oil proof
- Protection class IP67
- Measuring spindle is made of stainless steel
- Replacement probe tip M 2.5
- Clamping shank Ø 8 mm
- Rubber bellows
- Shockproof
- Outer ring (bezel) can be rotated through 360°
- DIN 878

### Delivery

- Fitted case

DIN 878



»	¼	Measuring span mm	Scale graduation value mm	Range per rev. mm	Outer ring (Bezel) Ø mm	Order no.	List price EUR
		3	0.01	0.5	44.5	0707 101	124.00
		10	0.01	1	61.5	0707 102	106.00



## 0700 Dial gauges, graduation 0.1 mm



0700 102



0700 104

### Model

- Metal housing
- Measuring spindle is made of stainless steel
- Replacement probe tip M 2.5
- Clamping shank Ø 8 mm
- Factory standard

### Delivery

- Fitted case

⌘	¼	Measuring span	Scale graduation value	Range per rev.	Outer ring (Bezel)	Order no.	List price
		mm	mm	mm	Ø mm		EUR
		10	0.1	10	40	0700 100	60.00
		5	0.1	5	40	0700 101	60.00
		10	0.1	10	58	0700 102	46.00
<b>Straight line revolution counter</b>							
		30	0.1	10	58	0700 104	53.00

## 0702 Dial gauge with concentric mm display



0702 106

### Model

- Metal housing
- Measuring spindle is made of stainless steel
- Replacement probe tip M 2.5
- Clamping shank Ø 8 mm
- With a concentric pointer
- DIN 878

### Delivery

- Fitted case

DIN  
878

⌘	¼	Measuring span	Scale graduation value	Range per rev.	Outer ring (Bezel)	Order no.	List price
		mm	mm	mm	Ø mm		EUR
		10	0.01	1	58	0702 106	61.00



## 0705 Precision dial gauges



0705 102

### Model

- Metal housing
- Measuring spindle is made of stainless steel
- Replacement probe tip M 2.5
- Clamping shank Ø 8 mm
- With a revolution counter
- Factory standard

### Delivery

- Fitted case

⌘	⌘	Measuring span mm	Scale graduation value mm	Range per rev. mm	Outer ring (Bezel) Ø mm	Order no.	List price EUR
		1	0.001	0.2	40	0705 102	108.00
		1	0.001	0.2	58	0705 104	108.00
		5	0.001	0.2	58	0705 105	113.00
<b>Precision shockproof dial gauge</b>							
		1	0.001	0.2	40	0705 107	115.00
		5	0.001	0.2	58	0705 109	140.00

3

## 0706 Error free, shockproof dial gauge



0706 102

### Model

- Metal housing
- Measuring spindle is made of stainless steel
- Replacement probe tip M 2.5
- Clamping shank Ø 8 mm
- DIN 878

### Delivery

- Fitted case

DIN  
878

⌘	⌘	Measuring span mm	Scale graduation value mm	Dial reading	Overtravel mm	Outer ring (Bezel) Ø mm	Order no.	List price EUR
		0.8	0.01	40-0-40	1	58	0706 102	70.00



## 0709 Dial gauges with reverse action plunger



### Model

- Metal housing
- Measuring spindle is made of stainless steel
- Replacement probe tip M 2.5
- Clamping shank  $\varnothing$  8 mm
- Factory standard

### Delivery

- Fitted case

✂	¼	Measuring span mm	Scale graduation value mm	Range per rev. mm	Outer ring (Bezel) $\varnothing$ mm	Order no.	List price EUR
		3	0.01	0.5	40	0709 101	104.00
		5	0.01	1	58	0709 108	124.00

## 0712 Dial comparator gauge MICROTAST



0712 121



0712 124

### Model

- Measuring spindle is made of hardened stainless steel
- Longer measuring spindle
- Replacement probe tip M 2.5
- Clamping shank  $\varnothing$  8 mm
- Tolerance markers
- Shockproof
- Fine adjustment
- DIN 879

### Delivery

- Fitted case

DIN  
879

✂	¼	Measuring span mm	Scale graduation value mm	Dial reading	Overtravel mm	Order no.	List price EUR
		0.5	0.01	25-0-25	2.5	0712 121	149.00
		0.1	0.001	50-0-50	3	0712 124	182.00



## 0710 Magnetic back



### Model

- For dial gauges with outer ring (Bezel) Ø 58 mm
- Allows dial gauges to be used without a holder or a stand
- Magnetic force 220 N
- Cannot be used in conjunction with dial gauges 0701 103 and 0701 106 or any digital gauges

»»	¼	Order no.	List price EUR
		0710 101	51.00

## 0710 Lug back

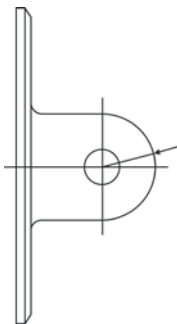

### Model

- Ø 5 mm
- For retrofitting
- Cannot be used in conjunction with dial gauges 0701 103 and 0701 106 or any digital gauges

»»	¼	Diameter	Order no.	List price EUR
<b>For dial gauges with an outer ring (Bezel) dia. 40 mm</b>				
		5 mm	0710 102	6.30
<b>For dial gauges with an outer ring (Bezel) dia. 58 mm</b>				
		5 mm	0710 103	6.50

## 0710 Spindle lifting lever

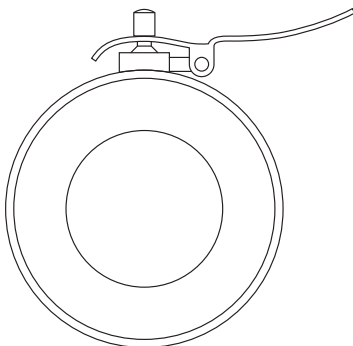

### Model

- For dial gauges with a measuring range max. 10 mm
- Cannot be used in conjunction with dial gauges 0701 103 and 0701 106 or any digital gauges

»»	¼	Order no.	List price EUR
<b>For dial gauges with an outer ring (Bezel) dia. 40 mm</b>			
		0710 104	10.10
<b>For dial gauges with an outer ring (Bezel) dia. 58 mm</b>			
		0710 105	10.10





## 0724 Angle lever attachment



### Model

- Clamping shank  $\varnothing$  8 mm
- Smallest measurable hole: 6 mm

### Delivery

- Excludes dial gauge

⌘	¼	Measuring depth mm	Order no.	List price EUR
		60	0724 101	46.00

## 0710 Extensions for dial gauges



### Model

- Special steel
- Thread M 2,5

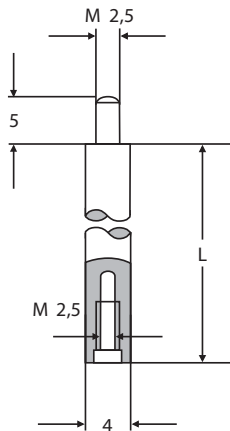

⌘	¼	Length mm	Order no.	List price EUR
		10	0710 111	4.30
		15	0710 112	4.30
		20	0710 113	4.30
		25	0710 114	4.30
		30	0710 115	4.30
		35	0710 116	4.30
		40	0710 117	4.30
		45	0710 118	4.30
		50	0710 119	4.30
		55	0710 120	4.30
		60	0710 121	4.30
		65	0710 122	4.30
		70	0710 123	4.30
		75	0710 124	4.30
		80	0710 125	4.30
		85	0710 126	4.30
		90	0710 127	4.30
		95	0710 128	4.30
		100	0710 129	4.30



0710 Measuring inserts M 2.5

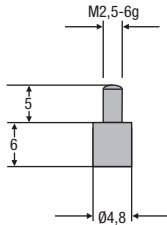

Material	Length mm	Order no.	List price EUR
Special steel	6	0710 161	3.50
Carbide	6	0710 261	23.80

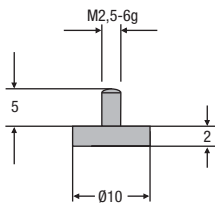

Material	Length mm	Order no.	List price EUR
Special steel	2	0710 162	4.50
Carbide	2	0710 262	38.40

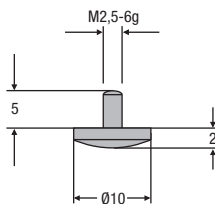

Material	Length mm	Order no.	List price EUR
Special steel	2	0710 163	5.20
Carbide	2	0710 263	46.30

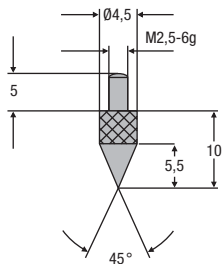

Material	Length mm	Order no.	List price EUR
Special steel	10	0710 164	5.20
Carbide	10	0710 264	44.80

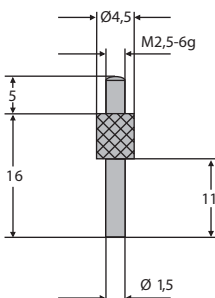

Material	Length mm	Diameter mm	Order no.	List price EUR
Special steel	16	1.5	0710 165	6.50
Carbide	16	1.5	0710 265	20.60



## 0710 Measuring inserts M 2.5

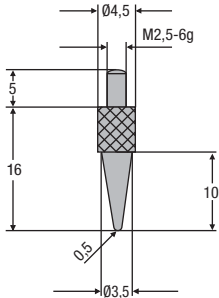

☒	☒	Material	Length mm	Order no.	List price EUR
		Special steel	16	0710 166	4.70

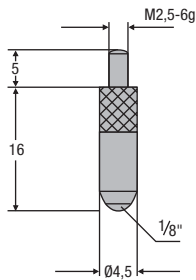

☒	☒	Material	Length mm	Order no.	List price EUR
		Special steel	16	0710 167	3.30
		Carbide	16	0710 267	10.90
		Ruby	16	0710 367	8.50
		Sapphire	16	0710 467	8.50

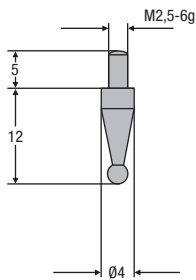

☒	☒	Material	Length mm	Ball diameter mm	Order no.	List price EUR
<b>Tolerance of the ball diameter +/- 1 µm</b>						
		Special steel	12	1	0710 169	6.50
		Special steel	12	1.5	0710 170	6.50
		Special steel	12	2	0710 171	6.50
		Special steel	12	2.5	0710 172	6.50
		Special steel	12	3	0710 173	6.50
		Special steel	12	3.5	0710 174	6.50
		Special steel	12	4	0710 175	6.50
		Special steel	12	4.5	0710 176	6.50
		Special steel	12	5	0710 177	6.50
		Special steel	12	5.5	0710 178	6.50
		Special steel	12	6	0710 179	6.50
		Special steel	12	6.5	0710 180	6.50

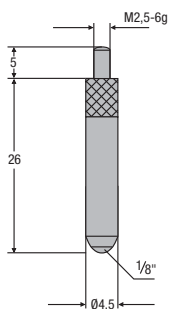

☒	☒	Material	Length mm	Order no.	List price EUR
		Special steel	26	0710 168	3.30
		Carbide	26	0710 268	10.90
		Ruby	26	0710 368	8.50
		Sapphire	26	0710 468	8.50



## 0710 Measuring inserts M 2.5

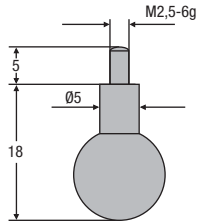

Material	Length mm	Ball diameter mm	Order no.	List price EUR
Special steel	18	7	0710 181	6.50
Special steel	18	7.5	0710 182	6.50
Special steel	18	8	0710 183	6.50
Special steel	18	8.5	0710 184	6.50
Special steel	18	9	0710 185	6.50
Special steel	18	9.5	0710 186	6.50
Special steel	18	10	0710 187	6.50
Special steel	18	10.5	0710 188	6.50
Special steel	18	11	0710 189	6.50

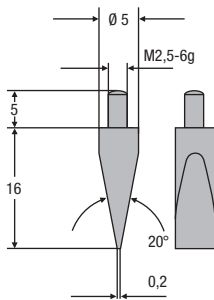

Material	Length mm	Order no.	List price EUR
<b>with locknut</b>			
Special steel	16	0710 192	6.90
Carbide	16	0710 292	48.70

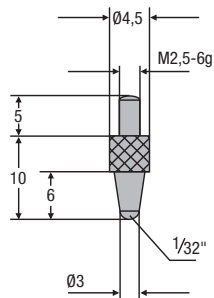

Material	Length mm	Order no.	List price EUR
Special steel	10	0710 193	3.50

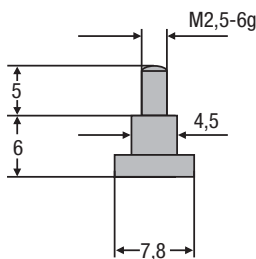

Material	Length mm	Order no.	List price EUR
Special steel	6	0710 194	4.70



## 0710 Measuring inserts M 2.5

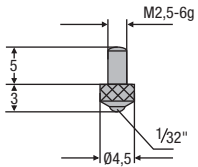

Material	Length mm	Order no.	List price EUR
Special steel	3	0710 195	1.10

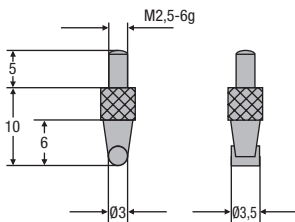

Material	Length mm	Diameter mm	Order no.	List price EUR
<b>with locknut</b>				
Special steel	10	3 x 3.5	0710 196	7.60

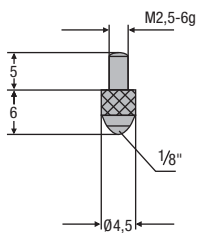

Material	Length mm	Order no.	List price EUR
Special steel	6	0710 197	1.10
Carbide	6	0710 297	4.50
Ruby	6	0710 397	6.10
Sapphire	6	0710 497	6.10



## 0715 Dial test indicators



0715 101



0715 201

### Model

- Carbide tipped measuring inserts, Ø 2.0 mm
- Form A in accordance to DIN 2270
- Revolving dial
- 3-piece swallow tail guide
- Automatic reversal of the counting direction
- Measuring force 0.15 N

### Delivery

- Fitted case

**DIN**  
**2270**

⊗	☰	Measuring range mm	Scale graduation value mm	Range per rev. mm	Stylus length mm	Dial reading	Outer ring (Bezel) Ø mm	Order no.	List price EUR
		± 0.4	0.01	0.8	14.5	0-40-0	30	0715 101	77.00
		± 0.4	0.01	0.8	14.5	0-40-0	40.5	0715 103	86.00
		± 0.25	0.01	0.5	41.2	0-25-0	30	0715 201	121.00
		± 0.1	0.002	0.2	14.5	0-100-0	40.5	0715 303	108.00
		± 0.1	0.002	0.2	14.5	0-100-0	30	0715 305	103.00
		± 0.5	0.01	0.5	32.3	0-50-0	40.5	0715 307	154.00

## 0715 Clamping shanks for dial test indicators

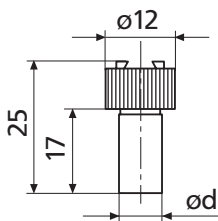

### Model

- With swallow tail mounting for dial test indicators and clamping nut

⊗	☰	Diameter	Order no.	List price EUR
		4h6	0715 903	11.60
		8h6	0715 907	11.60

## 0715 Measuring inserts with carbide ball

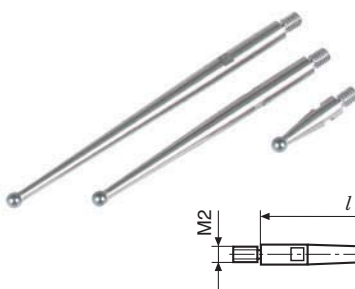

⊗	☰	Length mm	Ball diameter mm	Order no.	List price EUR
		14.5	1	0715 915	16.20
		14.5	2	0715 917	12.80
		14.5	3	0715 919	12.80
		32.3	1	0715 921	17.90
		32.3	2	0715 922	13.50
		32.3	3	0715 923	13.40
		41.2	1	0715 925	16.40
		41.2	2	0715 926	12.80
		41.2	3	0715 929	12.80



## 0715 Key for measuring inserts



⌘	⚙	Order no.	List price EUR
		0715 940	2.40

## 0715 Universal clamp

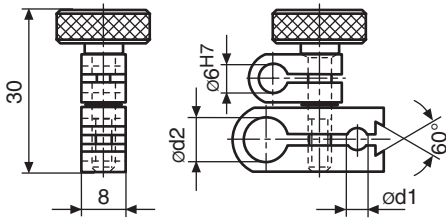

⌘	⚙	Diameter mm	Order no.	List price EUR
		8	0715 950	24.30

## 0715 Holder

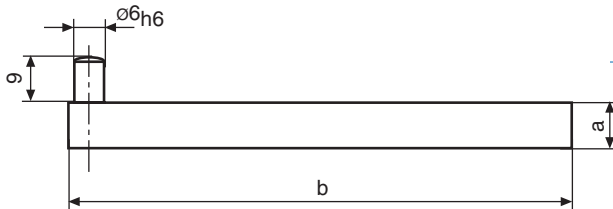

⌘	⚙	Length mm	Cross-section mm	Order no.	List price EUR
		100	9 x 9	0715 955	15.40



## 0716 Dial depth gauges with a measuring base



0716 101



0716 111

### Model

- Measuring base is made of stainless steel, hardened
- Replacement probe tip M 2.5
- Revolving dial
- Factory standard

### Delivery

- Cardboard box

⌘	⌘	Measuring range mm	Reading mm	Contact surface mm	Range per rev. mm	Scale dia. mm	Order no.	List price EUR
		0 - 10	0.01	100 x 15	1	58	0716 101	134.00
<b>Concentric pointer</b>								
		0 - 30	0.01	150 x 15	1	58	0716 102	196.00
		0 - 30	0.01	100 x 15	1	58	0716 105	176.00
<b>Prismatic base</b>								
		0 - 30	0.01	10 x 100	1	58	0716 111	259.00

3

## 0716 Depth measuring base for indicators



0716 192

### Model

- Special steel, chrome plated
- Mounting for indicator Ø 8 mm

### Delivery

- Cardboard box

⌘	⌘	Contact surface mm x mm	Order no.	List price EUR
		80 x 15	0716 192	57.00
		100 x 15	0716 194	70.00
		150 x 15	0716 196	90.00





## 0718 Dial thickness gauges



0718 101



0718 112



### Model

- Frame is made of aluminium alloy
- Factory standard
- When ordering please specify the gauge form

### Delivery

- Cardboard box

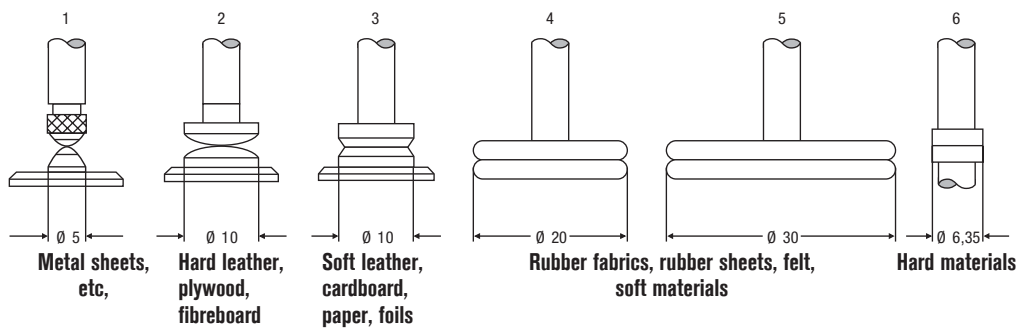

⊗	⊗	Measuring range mm	Reading mm	Frame depth mm	Probe type	Order no.	List price EUR
		0 - 10	0.1	15	1 / 2 / 3 / 6	0718 101	48.90
		0 - 20	0.1	50	1 - 5	0718 104	102.00
		0 - 30	0.1	50	1 - 5	0718 105	115.00
		0 - 50	0.1	50	1 - 5	0718 106	175.00
<b>With a lifting device and stand. range per revolution 10 mm</b>							
		0 - 30	0.1	200	1 - 5	0718 108	150.00
		0 - 30	0.1	300	1 - 5	0718 109	172.00
		0 - 30	0.1	400	1 - 5	0718 110	192.00
<b>With a lifting wheel and concentric pointers. range per revolution 1 mm</b>							
		0 - 10	0.01	18	1 / 2 / 3 / 6	0718 112	97.00
		0 - 10	0.01	45	1 / 2 / 3 / 6	0718 113	111.00
<b>With a lifting device. range per revolution 1 mm</b>							
		0 - 10	0.01	50	1 - 5	0718 115	115.00



0720 Dial thickness gauges



0720 102



0720 103

Model

- With a lifting device
- Factory standard
- Frame is made of alluminium alloy
- Revolution counter

- **Order No. 0720 102**  
Tube wall thickness dial gauge with 2 exchangeable probes  
- with bund radius = 10 mm, dia, 8 mm  
- cylindrical dia. 6 mm
- **Order No. 0720 103**  
Foil thickness measuring gauge, measuring insert dia. 6.35 mm. flat. thermally insulated

Delivery

- Cardboard box

»	¼	Measuring range mm	Reading mm	Range per rev. mm	Frame depth mm	Order no.	List price EUR
<b>Foil thickness dial gauge</b>							
		0 - 1	0.001	0.2	30	0720 103	218.00
<b>Tube wall thickness dial gauge</b>							
		0 - 10	0.01	1	50	0720 102	153.00



## 0721 Internal caliper gauges



0721 120

### Model

- Protection class IP65

### Delivery

- Cardboard box

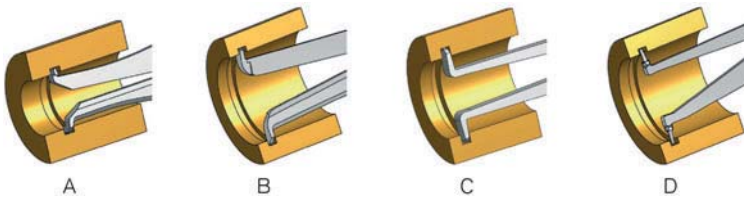

✕	¼	Measuring range mm	Measuring depth mm	Reading mm	Error limit mm	For grooves		Order no.	List price EUR
						max. depth	min. width		
<b>Contact point type „A“, cutting (chisel) radius 0.1 mm</b>									
		2.5 - 12.5	12	0.005	0.015	0.7	0.6	0721 100	491.00
<b>Contact point type „B“, carbide ball Ø 0.6 mm</b>									
		5 - 15	35	0.005	0.015	2.2	0.8	0721 101	491.00
<b>Contact point type „B“, carbide ball Ø 1.0 mm</b>									
		10 - 30	85	0.01	0.03	5.2	1.2	0721 120	509.00
<b>Contact point type „C“, carbide ball Ø 1.0 mm</b>									
		20 - 40	85	0.01	0.03	7	1.2	0721 121	509.00
		30 - 50	85	0.01	0.03	7	1.2	0721 122	509.00
<b>Contact point type „D“, carbide ball Ø 1.0 mm</b>									
		40 - 60	85	0.01	0.03	8.3	1.2	0721 123	509.00
		50 - 70	85	0.01	0.03	8.3	1.2	0721 124	526.00
		60 - 80	85	0.01	0.03	8.3	1.2	0721 125	526.00
		70 - 90	85	0.01	0.03	8.3	1.2	0721 126	526.00
		80 - 100	85	0.01	0.03	8.3	1.2	0721 127	526.00



## 0721 External caliper gauges



0721 144

### Model

- Protection class IP65

### Delivery

- Cardboard box

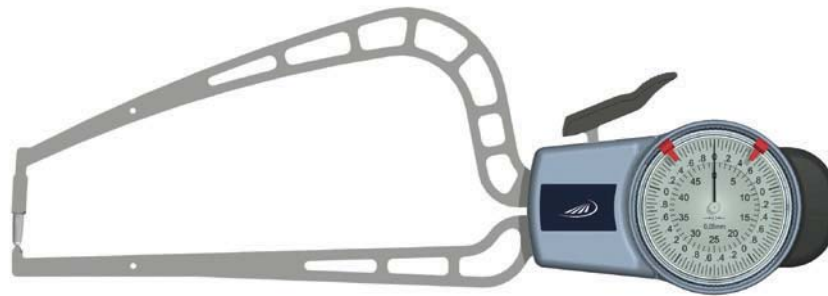

0721 149

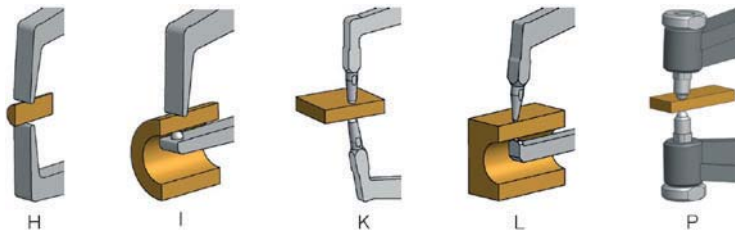

»	¼	Measuring range mm	Measuring depth mm	Reading mm	Error limit mm	Contact point length		Order no.	List price EUR
						moving mm	fixed mm		
<b>Contact point type „P“, carbide ball Ø 5.0 mm</b>									
		0 - 10	36	0.1	0.1	5	5	0721 140	139.00
<b>Contact point type „H“, cutting chisel radius 0.4 mm</b>									
		0 - 10	35	0.005	0.015	18.8	18.8	0721 141	491.00
<b>Contact point type „I“, fixed arm, carbide ball Ø 1.5 mm, moving arm, cutting (chisel) radius R = 0.4 mm</b>									
		0 - 10	35	0.005	0.015	18.8	0.9	0721 142	491.00
<b>Contact point type „K“, carbide ball Ø 1.5 mm</b>									
		0 - 10	35	0.005	0.015	19.1	18.6	0721 143	491.00
		0 - 20	85	0.01	0.03	24.6	24.6	0721 144	491.00
<b>Contact point „L“ carbide ball Ø 1.5 mm, 1 straight probe arm</b>									
		0 - 20	80	0.01	0.03	24.7	2.5	0721 145	491.00
<b>Contact point type „K“, carbide ball Ø 3.0 mm</b>									
		0 - 50	167	0.05	0.05	30	30	0721 148	748.00
<b>Contact point „L“ carbide ball Ø 3.0 mm, 1 straight probe arm</b>									
		0 - 50	169	0.05	0.05	30	4.6	0721 149	748.00



## 0721 Digital internal caliper gauges



0721 732



0721 738

### Model

- Protection class IP67

### Functions

- ON / OFF
- Set to zero at any point
- mm / inch switching
- PRESET-Function (setting a numerical value)
- TOL (tolerance value input)
- Data output

### Delivery

- Cardboard box

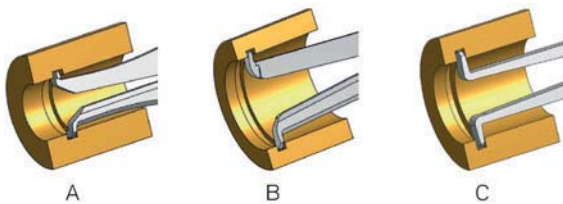

A

B

C

✕	%	Measuring range	Measuring depth	Reading	Error limit	For grooves		Order no.	List price
		mm	mm			mm	mm		
<b>Contact point type „B“, carbide ball Ø 0.6 mm</b>									
		5 - 15	35	0.005	0.015	2.3	0.8	0721 731	526.00
<b>Contact point type „C“, carbide ball Ø 1.0 mm</b>									
		10 - 30	85	0.01	0.03	5.2	1.2	0721 732	526.00
		20 - 40	85	0.01	0.03	7	1.2	0721 733	526.00
		30 - 50	85	0.01	0.03	7	1.2	0721 734	526.00
<b>Contact point type „C“, carbide ball Ø 1.3 mm</b>									
		13 - 43	127	0.02	0.04	5.7	1.6	0721 738	670.00
<b>Contact point type „D“, carbide ball Ø 2.0 mm</b>									
		50 - 80	132	0.02	0.04	8.3	2.4	0721 739	670.00
<b>Contact point type „C“, carbide ball Ø 1.5 mm</b>									
		15 - 65	188	0.02	0.06	5.5	1.9	0721 740	925.00



0721 Digital external caliper gauges



0721 745

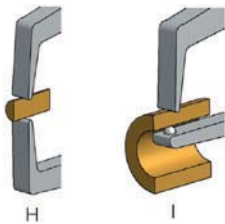

**Functions**

- ON / OFF
- Set to zero at any point
- mm / inch switching
- PRESET-Function (setting a numerical value)

- ABS (display can be set to zero without losing the Preset value)
- TOL (tolerance value input)
- Data output

**Delivery**

- Cardboard box

⌘	⌘	Measuring range mm	Measuring depth mm	Reading mm	Error limit mm	Contact point length moving	Contact point length fixed	Order no.	List price EUR
<b>Contact point type „K“, carbide ball Ø 1.5 mm</b>									
		0 - 20	85	0.01	0.03	24.6	24.6	0721 741	526.00
<b>Contact point type „K“, carbide ball Ø 3.0 mm</b>									
		0 - 30	116	0.02	0.04	30	30	0721 745	670.00
		0 - 50	167	0.02	0.05	30	30	0721 747	925.00
<b>Contact point „L“ carbide ball Ø 3.0 mm, straight lower probe arm</b>									
		0 - 30	116	0.02	0.04	30	4	0721 746	670.00

0721 Accessories for caliper gauges



0721 785

⌘	⌘	Description	Order no.	List price EUR
		Data interface (adapter and cable) for Digimatic	0721 785	140.00
		Data interface (adapter and cable) for USB	0721 786	140.00

When placing an order, please specify the order no. and the type of the caliper gauge.



## 0724 Internal bore gauges for blind holes



### Model

- 2 point comparator measuring instrument for measuring at the bottom of the bore
- Holder, measuring slides and contact pin carbide tipped
- Mounting hole  $\varnothing$  8 mm
- Ideal in conjunction with dial gauges or dial comparator gauges

### Delivery

- Wooden case
- Excludes dial gauge

**NEW**

✕	⚙	Measuring range mm	Front distance mm	Order no.	List price EUR
		20 - 50	1.5	0724 504	895.00
		50 - 110	1.5	0724 508	870.00
		110 - 300	2	0724 522	1215.00
		300 - 600	2	0724 530	2675.00

## 0724 Holder for internal bore gauges 0724



✕	⚙	For measuring range mm	Order no.	List price EUR
		20 - 50	0724 904	750.00
		50 - 110	0724 908	775.00
		110 - 300	0724 922	895.00
		300 - 600	0724 930	1180.00



## 0726 Internal precision bore gauges, set for smaller bores



0726 310

### Model

- 2 point comparator measuring instrument with split probe + measuring pin
- Excludes a dial gauge
- Without setting ring
- Mounting hole Ø 8 mm
- Ideal in conjunction with dial gauges or dial comparator gauges

### Delivery

- Wooden case

»	¼	Effective measuring range mm	Nominal meas. range mm	Measuring depth mm	Number of measuring probes pcs	Order no.	List price EUR
<b>Hardened chrome finished probe</b>							
		4.15 - 7.8	4.5 - 7.5	41	7	0726 310	665.00
		7.7 - 12.5	8.0 - 12.0	45	6	0726 311	681.00
		4.15 - 12.5	4.5 - 12.0	41	13	0726 312	1081.00
		12.2 - 20.6	13.0 - 20.0	45	8	0726 313	779.00
<b>Carbide tipped probe</b>							
		0.95 - 1.55	1.0 - 1.4	13	5	0726 500	670.00
		1.5 - 4.2	1.75 - 4.0	17	10	0726 501	956.00
		0.95 - 4.2	1.0 - 4.0	13	15	0726 502	1486.00
		4.15 - 7.8	4.5 - 7.5	41	7	0726 510	1018.00
		7.7 - 12.5	8.0 - 12.0	45	6	0726 511	971.00
		4.15 - 12.5	4.5 - 12.0	41	13	0726 512	1818.00
		12.2 - 20.6	13.0 - 20.0	45	8	0726 513	1122.00

## 0726 Accessories for 0726

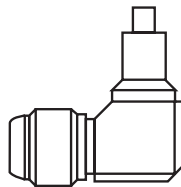
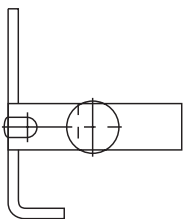

»	¼	For measuring range mm	Order no.	List price EUR
<b>Clamp with depth stop</b>				
		1 - 4	0726 122	143.00
		4.5 - 9	0726 123	131.00
		10 - 20	0726 124	124.00
<b>Angle probe 90°</b>				
		1 - 20	0726 130	227.00

## 0726 Set of setting rings

»	¼	For measuring range mm	Number of devices pcs	Order no.	List price EUR
		1 - 1.4	5	0726 300	292.00
		8 - 12	6	0726 301	293.00
		1 - 4	15	0726 302	930.00
		4.5 - 12	13	0726 303	660.00
		13 - 20	8	0726 304	410.00
		1.75 - 4	10	0726 305	504.00
		4.5 - 7.5	7	0726 306	327.00





## 0728 Internal precision bore gauges for large and deep bores



### Model

- 2 point comparator measuring instrument with split probe + measuring pin
- Centering plate
- Mounting hole Ø 8 mm
- Ideal in conjunction with dial gauges or dial comparator gauges

### Delivery

- Wooden case



✕	¼	Measuring range mm	Repeatability µm	Measuring depth mm	Measuring pins pcs	Measuring discs pcs	Order no.	List price EUR
<b>Fixed measuring pins, hardened special steel, interchangeable contact pins carbide tipped</b>								
		18 - 35	0.5	110	9	2	0728 105	379.00
		35 - 60	0.5	138	7	2	0728 106	369.00
		50 - 100	0.5	177	11	3	0728 107	421.00
		100 - 160	0.5	234	7	4	0728 108	587.00
		160 - 290	0.5	234	7	4	0728 109	847.00
		280 - 510	1.5	400	7	4	0728 110	2000.00
<b>Fixed measuring pins and interchangeable contact pins, both pins are carbide tipped</b>								
		4.5 - 6	0.5	80	9	-	0728 201	966.00
		6 - 8	0.5	100	7	-	0728 202	691.00
		8 - 12	0.5	100	9	-	0728 203	644.00
		12 - 20	0.5	110	9	1	0728 204	447.00
		18 - 35	0.5	110	9	2	0728 205	452.00
		35 - 60	0.5	138	7	2	0728 206	431.00
		50 - 100	0.5	177	11	3	0728 207	504.00
		100 - 160	0.5	234	7	4	0728 208	655.00
		160 - 290	0.5	234	7	4	0728 209	868.00
		280 - 510	1.5	400	7	4	0728 210	2047.00

## 0728 Setting device for internal precision bore gauges



### Model

- Setting device for accurate adjustment of internal precision bore gauges to the required nominal dimension, with gauge blocks
- The setting jaws are made of carbide and are lapped to gauge block quality
- Setting device can be used in both, the vertical and horizontal measuring axis

### Delivery

- Wooden case
- Incl. stand (excludes gauge blocks)

✕	¼	For measuring range mm	Error limit µm	Order no.	List price EUR
		4.5 - 160	2	0728 910	1195.00
		18 - 290	2	0728 915	1184.00
		160 - 510	2	0728 920	1714.00



## 0735 Crankshaft gauges

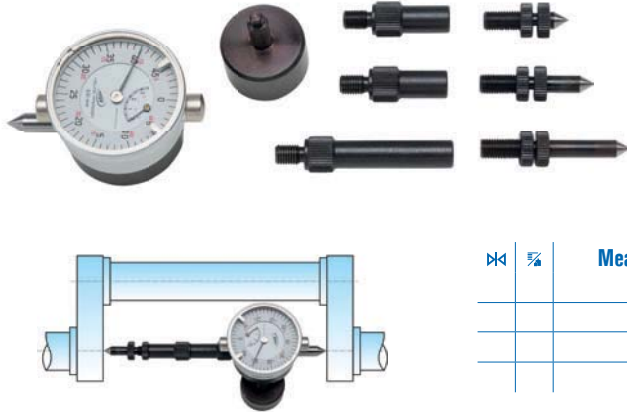

### Model

- With dial gauge
- To be positioned between 2 crank arms
- Centre punch is not required
- Horizontal position of the dial gauge is assured with a plumb bob

### Delivery

- Wooden case

»	¼	Measuring range mm	Reading mm	Order no.	List price EUR
		45 - 150	0.01	0735 101	392.00
		60 - 300	0.01	0735 102	353.00
		60 - 500	0.01	0735 103	410.00

## 0735 Replacement gauge for 0735

### Model

- For order no. 0735 102 and 0735 103

»	¼	Order no.	List price EUR
		0735 902	179.00

## 0736 Length measuring instruments for external incisions

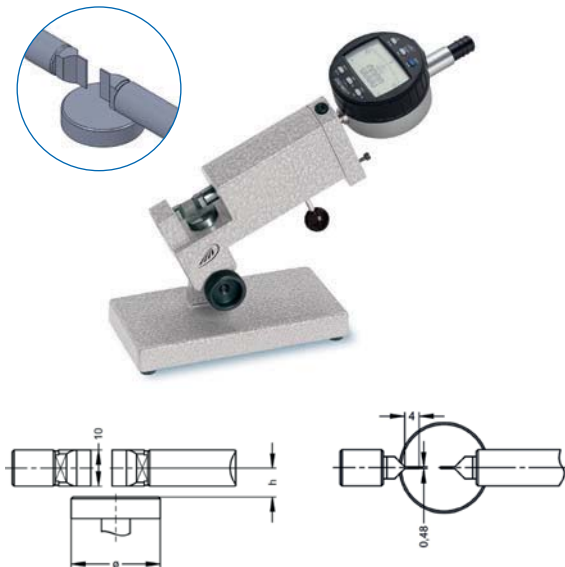

### Model

- Ideal for serial measurements of incision diameters on turned parts
- Narrow measuring faces
- High precision ball guide of the transmission bolt
- Round support table, height adjustable, clamped for setting the exact measuring position
- Heavy stand
- Base unit in the angular grid 0° / 30° / 60° / 90°
- Titled and clamped
- Support for indicators with shaft Ø 8 mm
- Display devices: analogue and digital indicators

- Versions with other measuring inserts are available upon request

### Delivery

- Cardboard box
- Without digital indicator (optional)

»	¼	Measuring range mm	Size of table dia. mm	Dimensions h mm	Order no.	List price EUR
		0 - 10	25 mm	8	0736 101	904.00
		0 - 25	38 mm	13	0736 102	975.00
		25 - 50	50 mm	35	0736 103	1044.00



## 0737 Length measuring instrument for internal incisions

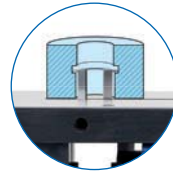

### Model

- Ideal for serial measurements of internal incision diameters
- High precision probe guidance with a constant measuring force
- Adjust the height with a gauge block
- Set the diameter with a setting ring
- Measuring table plate size 110 x 73 mm
- Mounting hole  $\varnothing$  8 mm
- Ideal for analogue and digital dial gauges as well as electronic probes
- Optional angled probes made of hardened steel

### Delivery

- Cardboard box
- Without indicator (optional)
- Without pair of measuring probes (optional)

		Measuring range internal mm	Order no.	List price EUR
		4 - 56	0737 101	880.00

## 0737 Measuring probes (pair) made of hardened steel for 0737

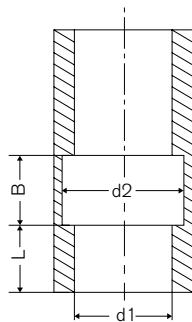

	For bore dia. „d1“ mm	Adjustable meas. height „L“ mm	Min. groove width „B“ mm	Max. incision dia. „d2“ mm	Order no.	List price EUR
	4 - 28	0 - 8	0.74	d1 + 2	0737 121	87.00
	6.5 - 30	0 - 10	1.00	d1 + 4	0737 122	87.00
	13 - 38	0 - 18	1.20	d1 + 2	0737 123	87.00
	20.5 - 51	0 - 25	1.20	d1 + 4	0737 124	87.00



## 0739 Universal comparator gauge



0739 124



0739 126

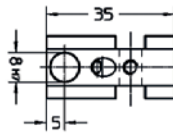

0739 164

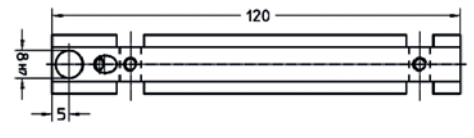

0739 165

### Model

- To determine internal and external diameters of recesses, grooves and undercuts in comparison measurement
- Measurement procedure: The part to be measured is determined at the point of reversal between a fixed and moveable measuring insert
- Select either an analogue or digital indicator to show your measuring results
- Sturdy construction
- Simple to set up and easy to operate
- Large range of application
- Ideal for serial measurements
- Optional: Special supporting table is interchangeable

- Repeatability: 2 µm
- Mounting hole for a dial gauge: Ø 8 mm

### Delivery

- Without digital indicator (optional)
- Incl. Pair of measuring inserts 0739 126 and 0739 124
- Incl. holder for measuring inserts 0739 164 and 0739 165
- In a practical aluminium case

Icon	Measuring range		Base dimensions mm	Order no.	List price EUR
	external mm	internal mm			
	0 - 180	21 - 200	150 x 150 x 68	0739 102	1708.00



## 0739 Measuring probes



0739 124

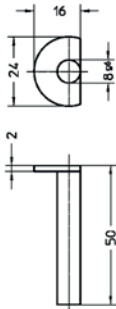

0739 125

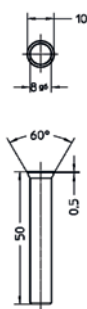

0739 126

⌘	⚡	Description	Order no.	List price EUR
		Probe pair	0739 124	103.00
		Probe pair	0739 125	107.00
		Probe pair	0739 126	61.00
		Pair of probe holders	0739 127*	98.00
		Pair of probe holders	0739 128*	61.00
		Pair of probe holders	0739 129*	118.00
		Probe pair	0739 130	99.00
		Small probe pair	0739 131**	107.00
		Holder pair for 0739131	0739 132	142.00

\* For further information regarding probes Ref. No. 0739 127 to 0739 129 see Ref. No. 0710 starting on page 137

\*\* Required holder No. 0739 132

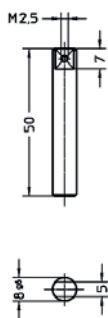

0739 127



0739 128

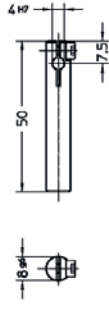

0739 129

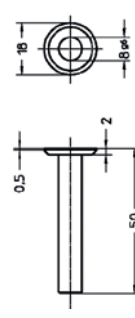

0739 130

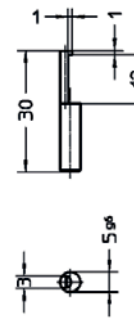

0739 131



0739 132

### Application examples:

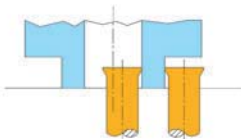

0739 126

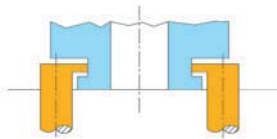

0739 124

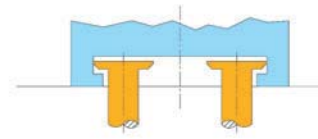

0739 130

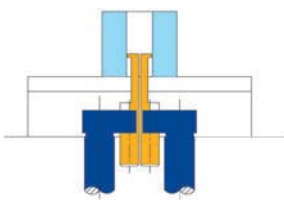

0739 131

0739 132

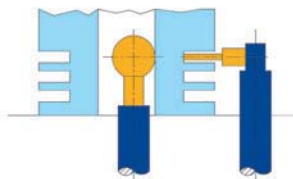

0739 127\*

0739 128\*

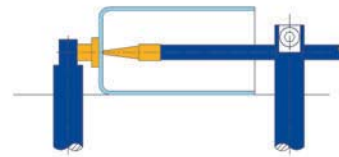

0739 129\*

0739 129\*



## 0739 Holder for measuring inserts short / long

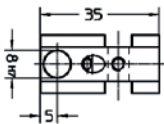

0739 164

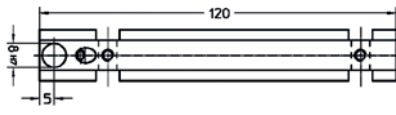

0739 165

Description	Length mm	Order no.	List price EUR
Holder, short	35	0739 164	37.00
Holder, long	120	0739 165	45.70

## 0739 Large supporting table

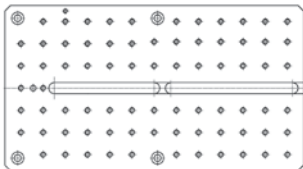

### Model

- Made of special steel with wear resistant surface coating
- Equipped with thread bore M5 in grid to attach stop elements
- Internal measurement: 21 - 220 mm
- External measurement: 0 - 300 mm

### Delivery

- With leg support to screw

Size of table mm	Order no.	List price EUR
269 x 149	0739 170	183.00

## 0739 Stop pieces

Description	Length mm	Width mm	Diameter mm	Dimensions h mm	Order no.	List price EUR
Stop cuboid	60	16		16	0739 121	87.00
Stop disc			24	16	0739 122	99.00
Stop stepped cuboid	60	25		16	0739 123	90.00

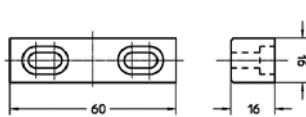

0739 121

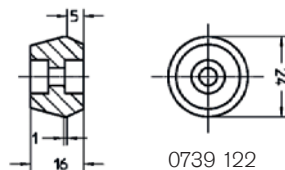

0739 122

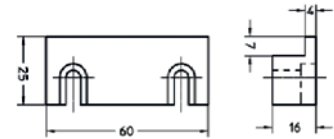

0739 123

### Application examples:

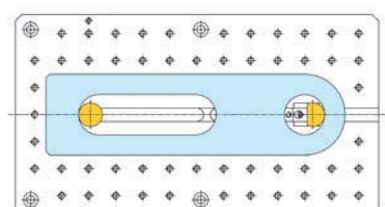
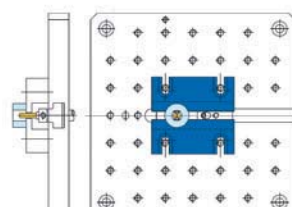
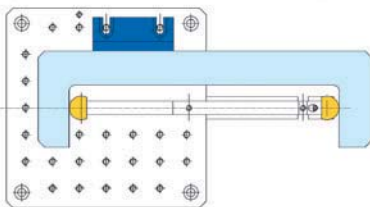
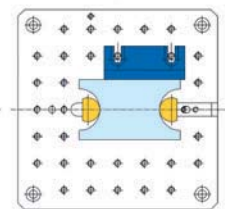
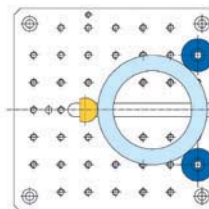
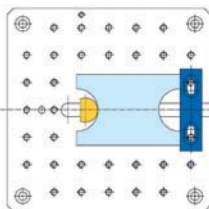
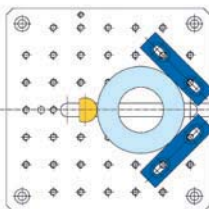



## 0741 Universal comparator gauge UHRTAST





## 0741 Comparator gauge UHRTAST



### Model

- Comparator gauge for **external and internal measurements** for checking workpieces and setting of machines
- Versatile in use due to wide range of probes and inserts
- Measuring range up to 2000 mm by using optional extensions
- Without indicator
- The direction of the measuring force can be switched, the gauge can be used for external and internal measurements
- The adjustment can be conducted with a setting gauge, a combination of gauge blocks, setting ring or a micrometer
- The measuring range of the moveable measuring arm is 18 mm

### Delivery

- Wooden case
- Basic instrument without digital indicator, measuring arms and measuring probes (optional)



Product video

	Measuring range		Measuring force	Order no.	List price
	external mm	internal mm	N		EUR
	5 - 220	15 - 230	10	0741 101	1787.00

## 0741 Pair of probe mounting block

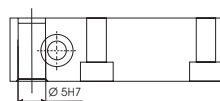

	Order no.	List price
		EUR
	0741 170	164.00

## 0741 Extensions



### Model

- Combinable with the basic instrument and further extensions by sticking together the pipe construction



0741 112



0741 114

	Length mm	Order no.	List price
			EUR
	100	0741 112	249.00
	200	0741 114	264.00
	500	0741 116	403.00





## 0741 Measuring inserts



0741 178

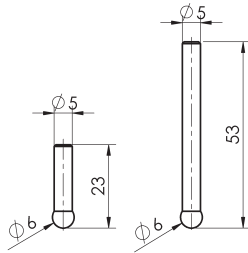

✕	¼	Length mm	Diameter mm	Order no.	List price EUR
		23	6	0741 178	110.00
		53	6	0741 179	110.00

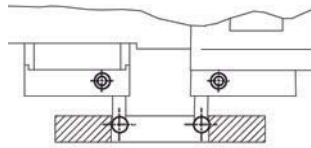

## 0741 Measuring inserts

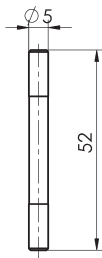

✕	¼	Length mm	Diameter mm	Order no.	List price EUR
		52	5	0741 180	110.00

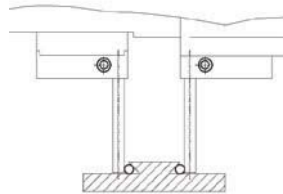

## 0741 Pair of offset measuring inserts

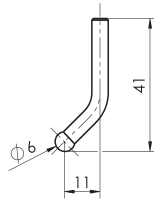

✕	¼	Length mm	Diameter mm	Order no.	List price EUR
		41	6	0741 182	183.00

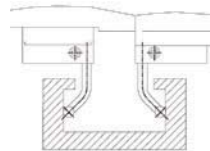

## 0741 Pair of measuring inserts with discs



✕	¼	Length mm	Width mm	Diameter mm	Dimensions h mm	Order no.	List price EUR
		42	10.5	12	2	0741 176	110.00

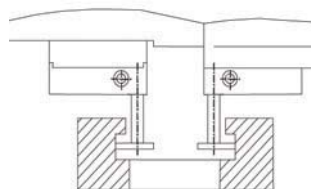
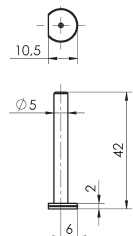



## 0741 Measuring inserts

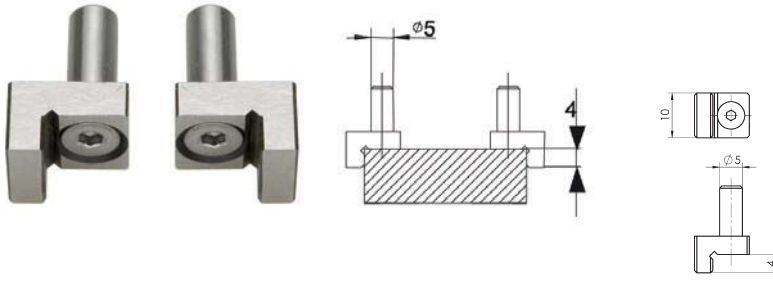

### Model

- For measuring external central points

Order no.	List price EUR
0741 172	196.00

## 0741 Pair of shoulder measuring inserts

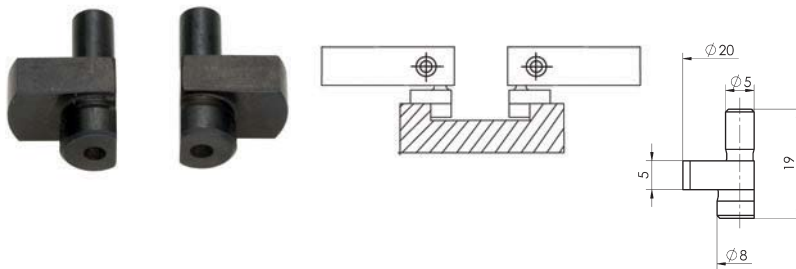

### Model

- For measuring internal central points

Order no.	List price EUR
0741 174	160.00

## 0741 Pairs of thread measuring inserts for metric external thread

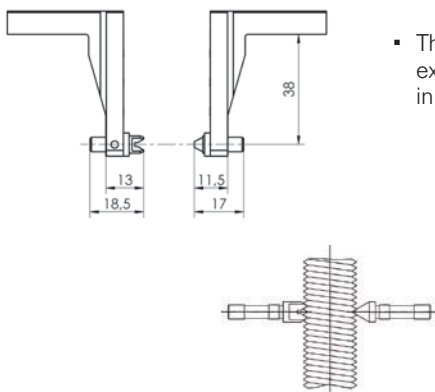

### Model

- Thread measuring inserts for external thread, metric pitch in pairs

Thread pitch mm	Order no.	List price EUR
0.35	0741 140	184.00
0.4 - 0.45	0741 141	104.00
0.5 - 0.6	0741 142	104.00
0.7 - 0.8	0741 143	104.00
1.0 - 1.25	0741 144	104.00
1.5 - 1.75	0741 145	104.00
2.0 - 2.5	0741 146	104.00
3.0 - 3.5	0741 147	104.00
4.0 - 5.0	0741 148	104.00
5.5 - 6.0	0741 149	104.00

## 0741 Pairs of thread measuring inserts for metric internal thread

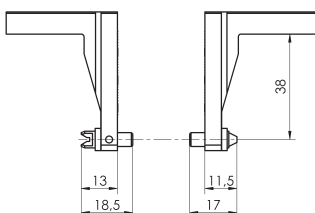

### Model

- Thread measuring inserts for internal thread, metric pitch in pairs

Thread pitch mm	Order no.	List price EUR
1.0 - 1.25	0741 163	210.00
1.5 - 1.75	0741 164	210.00
2.0 - 2.5	0741 165	210.00
3.0 - 3.5	0741 166	210.00
4.0 - 5.0	0741 167	210.00
5.5 - 6.0	0741 168	210.00



## 0741 Pairs of measuring arms



0741 122

### Model

- For mounting of adapter pieces and inserts with shaft- $\varnothing$  5 mm and  $\varnothing$  3.5
- With lasered help rule (mm-divide) as position help for the depth stop pieces



0741 124

✕	¼	Length mm	Order no.	List price EUR
		40	0741 122	259.00
		80	0741 124	311.00

## 0741 Pair of depth stop attachment for measuring arms



### Model

- To slide on measuring arms
- Can be clamped with grub screw

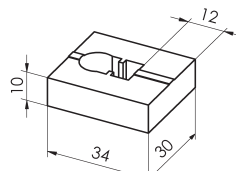

✕	¼	Length mm	Width mm	Height mm	Order no.	List price EUR
		34	30	10	0741 136	241.00

## 0741 Pair of adapters 5 mm for measuring inserts M2.5



### Model

- All measuring inserts for dial gauges with M2.5 can be used (measuring inserts please refer to pages 137-140)

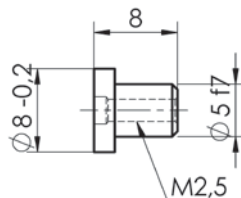

✕	¼	Order no.	List price EUR
		0741 132	84.00



## 0741 Pair of adapters for thread measuring inserts (pair)

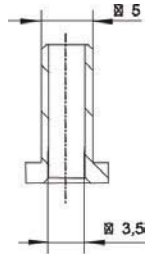

### Model

- Adapter for thread measuring inserts with a long shank (length 13.5 mm)

⌘	⌘	Order no.	List price EUR
		0741 134	146.00

## 0741 Measuring table



### Model

- Practical accessories to rebuild the UHRTAST to a fixed measuring device

### Delivery

- Cardboard box

⌘	⌘	Size of table mm	Order no.	List price EUR
		Ø 180	0741 184	623.00



## 0753 Universal indicator stands with magnetic base



0753 110



0753 120

### Model

- Chrome finished columns
- Base with V-groove
- Magnet with ON/OFF switch
- Mounting clamp: Ø 8 mm for indicators
- Integrated fine adjustment

### Delivery

- Cardboard box

✕	¼	Projection mm	Column height mm	Column dia. mm	Arm dia. mm	Base dimensions mm	Magnetic force N	Order no.	List price EUR
		140	230	16	12	60 x 50 x 55	500	0753 110	23.90
		180	285	16	16	70 x 46 x 65	600	0753 120	59.00



## 0750 Universal indicator stands with magnetic base and combi clamp



0750 101

### Model

- Chrome plated columns
- Base with V-groove
- Magnet with ON/OFF switch
- Combi clamp: Ø 8 mm for dial gauges, swallow tail clamp for dial test indicators
- Intergrated fine adjustment

### Delivery

- Cardboard box

### Accessories

wooden case for magnet - measuring support

Order no.	List price EUR
0750 601	24.10

»	¼	Projection mm	Column height mm	Column dia. mm	Arm dia. mm	Base dimensions	Magnetic force N	Order no.	List price EUR
<b>Crosshead clamp</b>									
		180	285	16	16	70 x 46 x 65	600	0750 101	134.00
		180	500	20	16	75 x 60 x 102	800	0750 102	179.00

## 0750 Pillar with transverse arm and fine adjustment



### Model

- Chrome plated column and transverse bar
- Mounting for indicator:
  - shank mounting Ø 8 mm for dial gauges
  - swallow tail clamp for dial test indicators
- Integrated fine adjustment

»	¼	Thread	Projection mm	Column height mm	Column dia. mm	Arm dia. mm	Description	Order no.	List price EUR
		M10	180	285	16	16	for 0750 101	0750 121	82.00
		M12	180	500	20	16	for 0750 102	0750 122	92.00

## 0750 Magnetic base



0750 111

### Model

- Magnetic base with V-groove
- Cling to flat and cylindric parts
- Magnetic force can be switched On / Off by rotary switch can

»	¼	Thread	Base dimensions	Magnetic force N	Order no.	List price EUR
		M10	70 x 46 x 65	600	0750 111	57.00
		M12	75 x 60 x 80	800	0750 112	105.00



## 0751 Magnetic indicator stands with flexible arm



0751 103



0751 104

### Model

#### ▪ 0751 103:

- with flexible arm
- holding force by rope tension on hinge segments
- switch magnetic base

#### ▪ 0751 104:

- fixed column
- with fine adjustment
- flexible transverse arm
- switch magnetic base

### Delivery

- Cardboard box

⌘	⚙	Column height mm	Column dia. mm	Base dimensions mm	Magnetic force N	Order no.	List price EUR
<b>Heavy duty stand</b>							
		350	-	70 x 45 x 65	600	0751 103	113.00
<b>Clamping via the star knob screw</b>							
		350	16	70 x 45 x 65	600	0751 104	132.00

## 0754 Universal magnetic holder



### Model

- Magnetic base with V-groove
- With mounting hole Ø 8 mm
- Three-sided magnet

### Delivery

- Cardboard box

⌘	⚙	Column height mm	Base dimensions mm	Magnetic force N	Order no.	List price EUR
		57	70 x 35	260	0754 101	95.00



## 0752 Magnetic indicator stands with central lock



0752 101



0752 103

3

### Model

- Column / Arm:
  - 0752 101 steel, chrome finished
  - 0752 103 aluminium, anodized
- Switch magnetic base with V-groove
- Central magnetic clamping system

- **Combi clamp:** Ø 8 mm for dial gauges, swallow tail clamp for dial test indicators
- Intergrated fine adjustment

### Delivery

- Cardboard box

☒	☒	Projection mm	Column height mm	Column dia. mm	Base dimensions mm	Magnetic force N	Order no.	List price EUR
		260	310	10	70 x 46 x 65	600	0752 101	138.00
		320	370	18	70 x 46 x 65	600	0752 103	177.00

## 0756 Universal magnetic holder



### Model

- Cast iron base with two magnets on the bottom of the holder
- With mounting hole Ø 8 mm

### Delivery

- Cardboard box

☒	☒	Column height mm	Base dimensions mm	Magnetic force N	Order no.	List price EUR
		45	72 x 37	180	0756 101	57.00





## 0770 Compact measuring stands



0770 102



0770 103



0770 201

### Model

- Cast base
- Chrome finished columns
- Hardened steel table
- With dust grooves (Order No. 0770 102 non-stop plane)
- With mounting hole for dial gauges  $\varnothing$  8 mm

### Delivery

- Cardboard box

✂	📏	Measuring height mm	Projection mm	Size of table mm	Column dia. mm	Arm dia. mm	Order no.	List price EUR
<b>With fixed arm</b>								
		100	49	$\varnothing$ 50	22	-	0770 102	169.00
		100	49	60 x 68	22	-	0770 103	214.00
<b>With adjustable transverse arm</b>								
		100	100	60 x 68	22	18	0770 201	216.00
		150	135	98 x 115	28	20	0770 205	335.00



## 0772 Measuring stand



### Model

- Cast base
- Hardened steel table
- With dust grooves
- With a threaded column and an adjustable transverse arm
- With mounting hole for dial gauges Ø 8 mm

### Delivery

- Cardboard box

»	☒	Measuring height	Projection	Size of table	Column dia.	Arm dia.	Order no.	List price
		mm	mm	mm	mm	mm		EUR
		160	200	170 x 215	35	22	0772 024	728.00

## 0785 Precision measuring stands



### Model

- Base made of hard stone
- Base plate accuracy according to DIN 876-00
- With a threaded column
- With adjustable transverse arm
- With mounting hole for dial gauges Ø 8 mm
- Vertical adjustment by threaded spindle with setting ring

### Delivery

- Cardboard box

»	☒	Measuring height	Projection	Size of table	Column dia.	Arm dia.	Order no.	List price
		mm	mm	mm	mm	mm		EUR
		200	200	150 x 260	35	22	0785 108	613.00
	▪	220	220	300 x 350	35	22	0785 109	1502.00
		<b>Anti-twist (secured against rotation) transverse arm</b>						
	▪	220	220	300 x 350	35	22	0785 110	1727.00



## 0763 Universal measuring support



### Model

- Column and transverse arm chrome plated
- Column is moving and can be clamped in the T-groove
- Heavy base plate with prismatic base and T-groove
- Mounting for display devices:
  - support for indicators with shaft  $\varnothing$  8 mm, swallow tail clamp for dial test indicators
- Integrated fine adjustment

### Delivery

- Cardboard box

✂	⚖	Projection mm	Column height mm	Column dia. mm	Arm dia. mm	Base dimensions mm	Order no.	List price EUR
		180	300	16	16	250 x 60 x 35	0763 100	268.00



## 0780 Bench centres

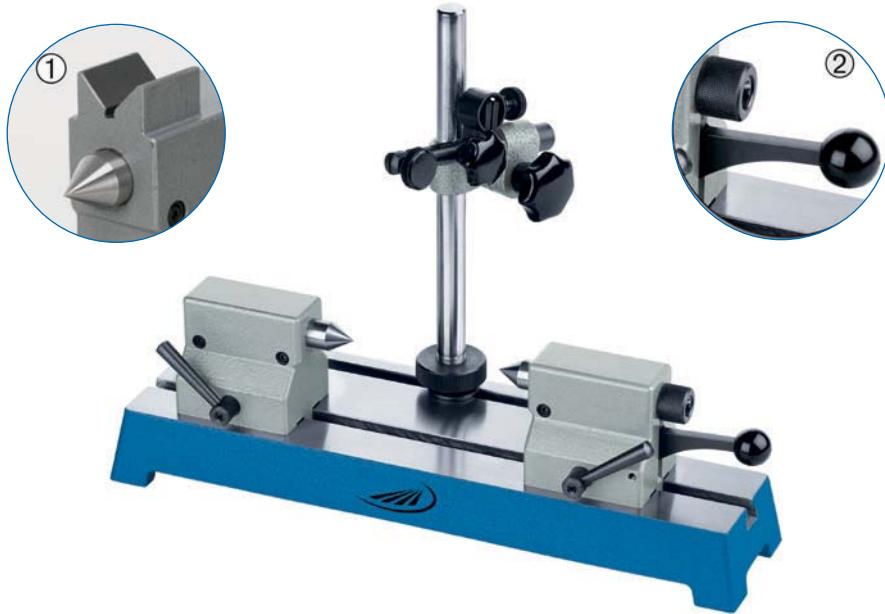

3

### Model

- Finely ground surface, flatness tolerance according to DIN 876-2
- With two adjustable tailstocks
- Left tailstock with fixed centre
- Right tailstock with retractable spring mounted centre, free lift appr. 10 mm

### Delivery

- Tailstocks can be clamped via an eccentric clamp
- Tailstock height 75 mm with integrated V-groove support
- Quick-clamping device by clamping lever
- With T-groove and support column
- With mounting hole for dial gauges Ø 8 mm

»	▣	Height of centers	Workpiece load	Distance between centres	Centre dia.	T-groove width	Base	Order no.	List price
		mm	p. tailstock max. kg	mm	mm	mm	mm		EUR
		50	5	200	16	10	350 x 110	0780 101	581.00
		50	5	350	16	10	500 x 110	0780 102	737.00
		75	5	200	16	10	350 x 110	0780 104	664.00
		75	5	350	16	10	500 x 110	0780 105	756.00
	▪	100	20	450	22	12	700 x 180	0780 107	1904.00
	▪	150	20	450	22	12	700 x 180	0780 108	2123.00

\* With integrated V-groove support on the tailstocks



## 0780 Bench centres for heavy workpieces



### Model

- Finely ground surface, flatness tolerance according to DIN 876-2
- With two adjustable tailstocks
- Left tailstock with fixed centre
- Right heavy tailstock with moveable, spring mounted centre. free lift appr, 10 mm
- Tighten by hand crank
- Tailstock can be clamped via an eccentric clamp
- Base made of cast iron with T-groove
- Measuring stand with mounting hole for dial gauges Ø 8 mm

### Delivery

- Cardboard box

✕	☞	Height of centres	Workpiece load p.	Distance	Centering tip dia.	T-groove width	Base	Order no.	List price
		mm	tailstock max. kg	between centres	mm	mm	mm		EUR
	▪	100	40	450	22	12	700 x 180	0780 141	2031.00
	▪	150	40	450	22	12	700 x 180	0780 142	2298.00

## 0780 Pair of v-support inserts



### Model

- V-support inserts to place in and for testing of shafts without centerbores
- V-support inserts are exchanged for the pointed alignment centre of the tailstocks



✕	☞	For height of centres	Contact surface	Order no.	List price
		mm	mm		EUR
		50/75	3 - 15	0780 021	84.00
		100	8 - 45	0780 023	128.00

## 0780 Replacement support column



### Model

- Column is moving and can be clamped in the T-groove
- Mounting for indicator:
  - Shaft mounting Ø 8 mm for dial test indicators
- Integrated fine adjustment



✕	☞	For height of centres	Projection	T-groove width	Column height	Column dia.	Arm dia.	Order no.	List price
		mm	mm	mm	mm	mm	mm		EUR
		50/75	105	10	200	18	14	0780 072	101.00
		100	105	12	240	18	14	0780 073	177.00
		150	105	12	440	18	14	0780 074	203.00



## 0780 Left tailstocks with a rotating collet chuck



### Model

- The left tailstock can be changed because of this specification with a collect chuck
- The collect chuck is rotatable for runout testing
- T grooves bearing
- Eccentric clamp

Height of centers mm	T-groove width mm	Order no.	List price EUR
<b>For collet chucks type F10 (Ø 1 - 7 mm)</b>			
50	10	0780 001	361.00
75	10	0780 002	400.00
<b>For collet chucks type F14 (Ø 1 - 10 mm)</b>			
100	12	0780 003	623.00

- Collet chucks F10 from 1-7 mm are available upon request
- Collet chucks F14 from 1-10 mm are available upon request

## Pair of replacement tailstocks for 0780

### Model

- 2 tailstocks made of cast iron, with T grooves bearing, with eccentric clamp
- Left tailstock with fixed centre
- Right tailstock with retractable spring mounted centre and clamping lever (quick-clamping device)

Height of centers mm	Workpiece load p. tailstock max. kg	T-groove width mm	Order no.	List price EUR
50	5	10	0780 091	365.00
75	5	10	0780 092	410.00
100	20	12	0780 093	844.00
150	20	12	0780 094	872.00

## Pair of V-groove supports for 0780



### Model

- For workpieces without centering
- Functional test through applying on e.g. plain lateral surface
- Recognition of form errors
- For exchange of centre supports
- Prismatic contact surface 90°
- V-groove surfaces made of hardened steel (replaceable)
- T grooves bearing
- Eccentric clamp

Height of centers mm	T-groove width	Contact surface mm	Order no.	List price EUR
65	10	5 - 25	0780 032	155.00
100	12	5 - 50	0780 033	222.00

\* based on the center of an axis of a shaft Ø 10 mm

## Pair of roller supports for 0780



### Model

- For exchange of centresupports
- Ball bearing rollers for easy turning of the workpieces

Height of roller supports mm	T-groove width	Contact surface mm	Order no.	List price EUR
65	10	3 - 30	0780 042	185.00
100	12	4 - 60	0780 043	250.00

\* based on the center of an axis of a shaft Ø 10 mm



## 0783 Bench centre



DIN  
876-1



### Model

- Dark granite work bench
- Flatness tolerance in accordance to DIN 876-1
- Right tailstock with retractable spring mounted centre (quick adjustment lever)
- Left tailstock with fixed centre
- Tailstocks can be adjusted via an eccentric clamp

### Delivery

- Wooden handling case
- Included:
  - Work bench
  - Support post
  - 1 pair of tailstocks with pointed alignment centre 60° MK 2

☒	☒	Height of centers mm	Workpiece load p. tailstock max. kg	Distance between centres mm	T-groove width mm	Base mm	Order no.	List price EUR
▪		200	24	650	14	1100 x 180	0783 012	3402.00

Accessories	Order no.	List price EUR
Pair of pointed alignment centres	0782 181	216.00
Tailstock	0782 191	1125.00
Measuring support	0783 070	284.00

## 0782 Pair of roller supports



### Model

- For exchange of centre supports
- Ball bearing rollers for easy turning of the workpieces
- T-grooves bearing
- Eccentric clamp

☒	☒	Height of roller supports mm	T-groove width mm	Contact surface mm	Order no.	List price EUR
		200	14	25 - 100	0782 160	678.00



0784 Concentricity measuring gauge with disc supports

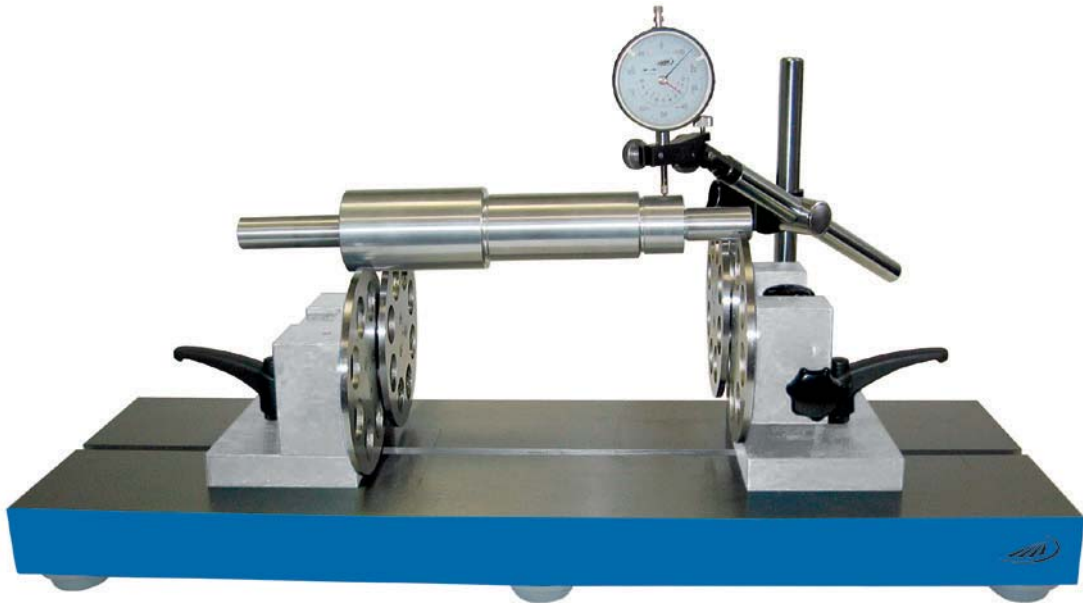

3

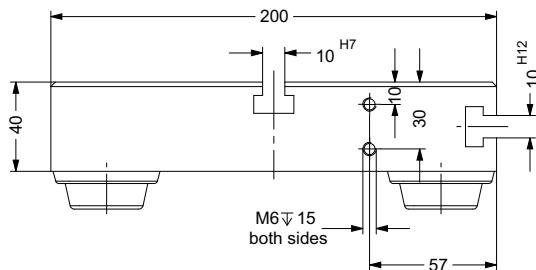

**Model**

- Centerless concentricity measuring instrument
- High accuracy discs are being mounted on bearings; free of play
- Discs can be slid to either side on the base

**Delivery**

- One sliding disc can be adjusted up to 30 mm for diametral compensation
- Concentricity accuracy < 5 μm
- wooden case
- includes the support post, excludes a dial gauge

	Workpiece load p. tailstock max. kg	Distance between the end mm	Disc diameter mm	Max. workpiece dia. mm	Order no.	List price EUR
▪	25	400	120	250	0784 108	2976.00





## 0788 Shaft measuring instrument



### Model

- For rapid measurement of diameters, distances, shoulders, taper, roundness, etc.
- For vertical and horizontal alignment
- Vertical base with 3 hardened adjustment support surfaces
- Measuring beam is made of hardened steel
- Load capacity horizontal max. 20 kg

### Delivery

- Cardboard box
- Without measuring support, guideway, dial gauge (optional accessories)



application as a bench centre

⊗	⊗	Height of centres mm	Distance between centres mm	T-groove width mm	Base mm	Order no.	List price EUR
▪		75	550	10 H7	200 x 120	0788 104	1085.00

Accessories	Order no.	List price EUR
Support arm with guideways	0788 180	220.00



0788 180



## 0788 Shaft measuring instrument lightweight



### Model

- For rapid measurement of distances, shoulders, taper, roundness, etc.
- Vertical and horizontal alignment
- Vertical base with 3 hardened adjustment support surfaces
- Measuring beam is made of hard anodized aluminium profile
- Aluminium tailstocks
- Load capacity horizontal max. 15 kg

### Delivery

- Cardboard box
- Without measuring support, guideway, dial gauge (optional accessories)



application as a bench centre

3

✕	¼	Height of centers mm	Distance between the end mm	T-groove width mm	Base mm	Order no.	List price EUR
		75	550	10.1 +0.1	200 x 150	0788 904	864.00

### Accessories

	Order no.	List price EUR
Support arm with holder	0788 980	70.00
Support arm with guideways	0788 990	313.00



0788 980



0788 990